

Planning Permit No. A/1462/91

APPROVED

SUBJECT TO THE CONDITIONS IN THIS OFFICE LETTER.

No. A 3/2254/91. Date 2/12/91

o/c Platformary

FOR MEMBER PLATFORMARY
MADRAS METROPOLITAN
DEVELOPMENT AUTHORITY
(1922) (23) 601008

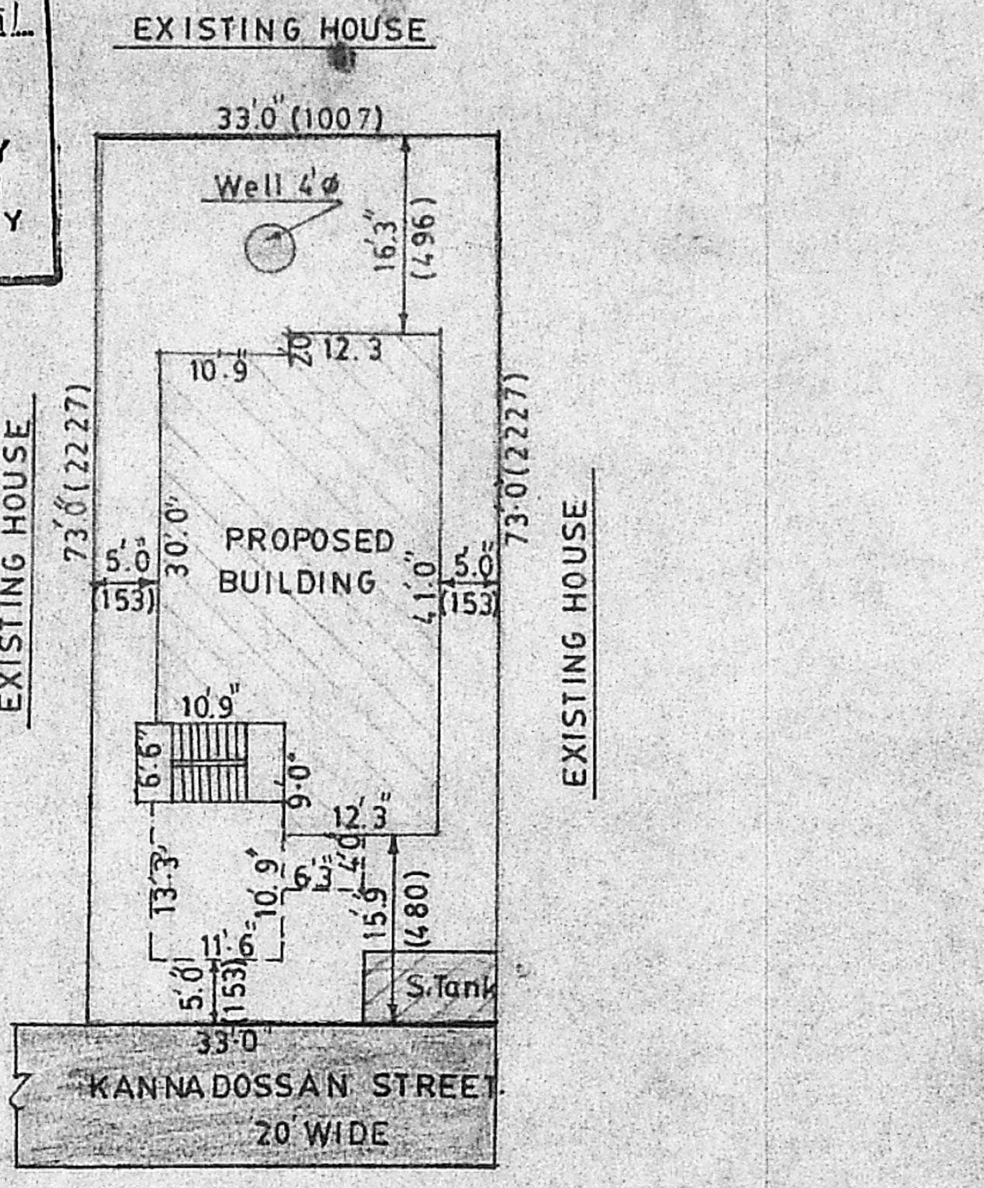

PLAN SHOWING THE PROPOSED CONSTRUCTION OF THE RESIDENTIAL BUILDING IN PLOT No. 2, S.No 187/2 Pt. CHITLAPAKKAM VILAGE SAIDAPET TALUK CHENGALPATTU DISTRICT MADRAS

SCALE 1"=8'0" (1:100)

REFERENCE :-

D. DOOR	3'0"X 6'6" (091X198)
D1. DOOR	2'6"X 6'6" (076X198)
W. WINDOW	4'6"X 4'0" (137X122)
W1. WINDOW	3'0"X 4'0" (091X122)
V. VENTILATER	3'0"X 1'6" (091X122)

AREA :-

PROPOSED PLINTH AREA	950 sft (88.25sqm)
SITE EXTENT	2409 sft (223.80sqm)

COLOUR INDEX :-

PROPOSED WORK	
BOUNDARY	
ROAD	

(Signature)
(Thiru.P.RAMASAMY)
OWNER

(Signature)
V. KRISHNAMURTHI, AMISE,
LICENCED SURVEYOR CLASS-I
CORPORATION OF MADRAS. NO. 5
Plot No. 543, 20th Street, Sector-4,
K.K. NAGAR, MADRAS-600 078.
ENGINEER